

THE ENTIRE PREMISES MAY BE USED FOR THE SALE OF ALCOHOL

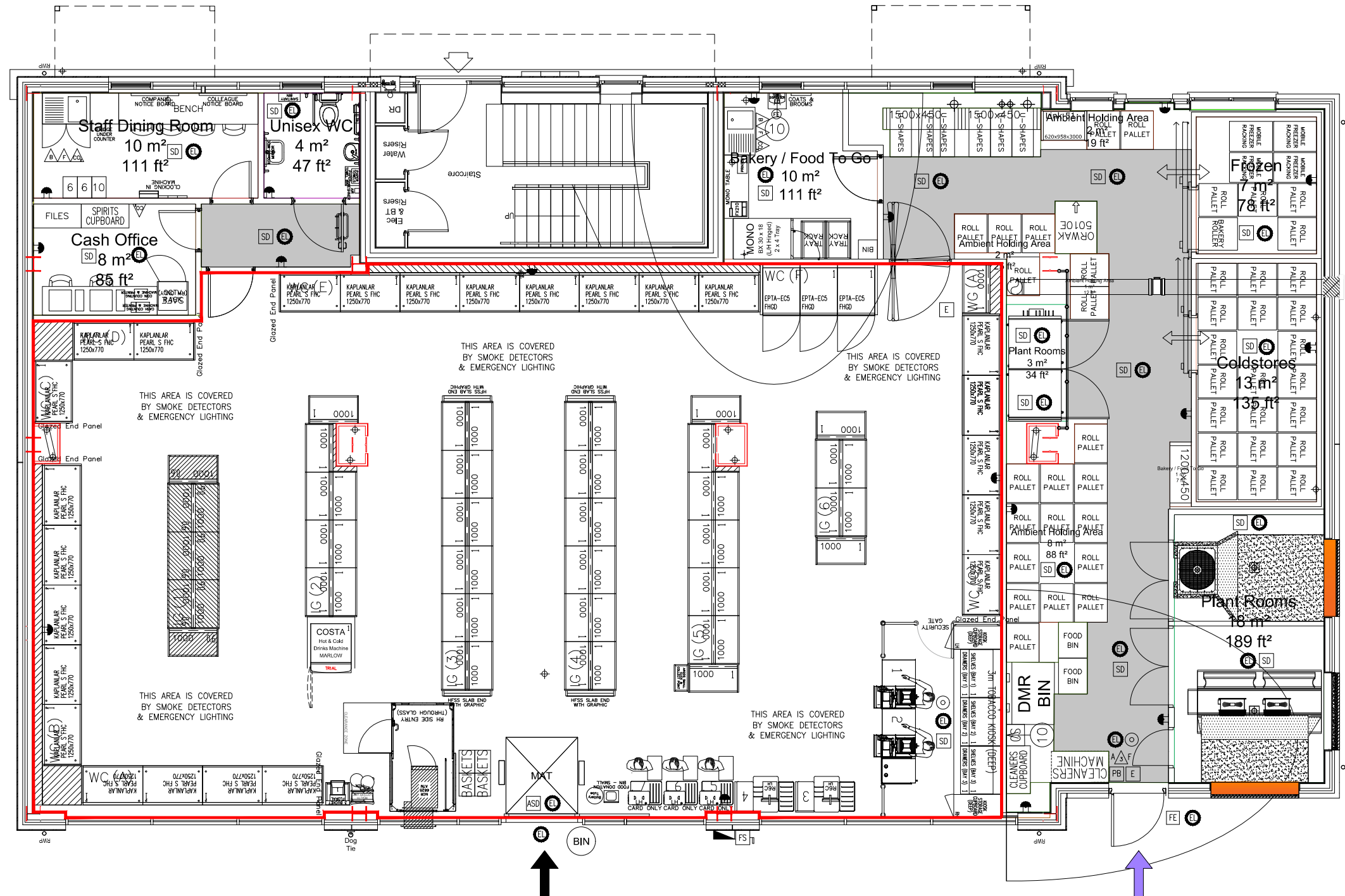

NOTES

DO NOT SCALE

REVISIONS

LEGEND

DESCRIPTION	DESCRIPTION
[PB]	PUSH BAR
[FS]	FIREMANS SWITCH
[C]	FIRE ALARM CALL POINT
[W]	FIRE EXTINGUISHER WATER
[F]	FIRE EXTINGUISHER FOAM
[D]	FIRE EXTINGUISHER DRY POWDER
[C]	FIRE EXTINGUISHER CARBON DIOXIDE
[B]	FIRE BLANKET
[M]	AFF MULTIPURPOSE EXTINGUISHER
[R]	FIRE FIGHTING HOSE REEL
[E]	FIRE EXIT DOORS
[A]	AUTOMATIC SLIDING DOORS
[M]	DOORS WITH ELECTRO MAGNETIC LOCKS
[E]	EXIT SIGN (RUNNING MAN)
[SD]	SMOKE DETECTOR CEILING MOUNTED
[H]	HIDDEN FIRE DETECTOR
[B]	FIRE ALARM BELL
[P]	FIRE ALARM PANEL
[S]	AUTOMATIC SPRINKLER POINTS
[L]	EMERGENCY LIGHTING POINT
[E]	EMERGENCY LIGHTING ILLUMINATED EXIT BOX

**5160**  
YATE, LADDEN GARDEN VILLAGE

PROPOSED  
GROUND FLOOR  
STORE PLAN

LICENSING MANAGER	JOANNE SURGUY	AGENCY	CAD
DRAWING CREATION	03.03.2023	SCALE	1:100
DRAWING NUMBER	5160G01-1	REVISION	-

**Sainsbury's**  
STORE DEVELOPMENT GROUP | SAINSBURY'S SUPERMARKETS LTD.  
33 HOLBORN, LONDON, EC1N 2HT  
TELEPHONE: 020 7695 6000 FAX: 020 7695 7610