

Acad Ref: I:\TMS Schemes\1439-BRADLEY STOKES\20 - Baileys Court Primary School - mandatory school keep clear markings\5_Docs & Drawings\Drawings\T439-220-01_Existing.dwg - Plotted by KH13 on Dec 03, 2019 - 7:32pm

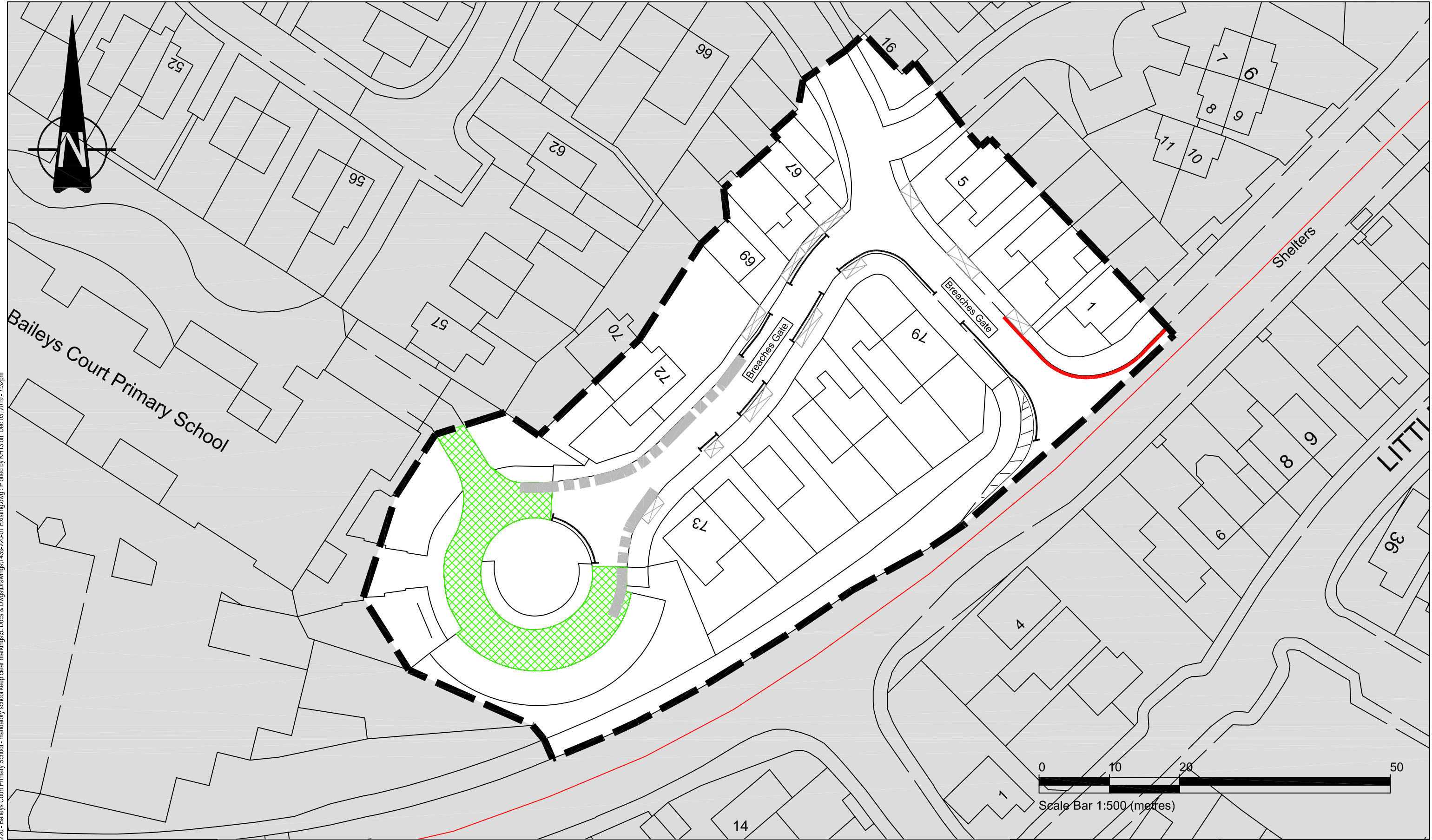

ORDNANCE SURVEY

© Crown copyright and database rights 2019 Ordnance Survey 100023410. This map has been provided for this scheme consultation and must not be used for any other purpose. Only one paper copy may be made for your own use.

Rev	Description	Drawn	App'd	Date

KEY	
	Scheme Boundary
	Advisory School Keep Clear
	Existing No Waiting at Any Time
	Advisory Keep Clear Line
	Dropped kerb/ access way
	Private land/ School area

CONSULTATION



South Gloucestershire Council
DEPARTMENT OF ENVIRONMENT AND COMMUNITY SERVICES

DIRECTOR
Nigel Riglar

STREETCARE TRANSPORT & WASTE
PO Box 1954
Bristol, BS37 0DD
Telephone: 01454 868 000
Email: TransportServices@southglos.gov.uk

Project		Baileys Court Primary School Waiting Restriction Review			
Title		Existing Restrictions			
Scale @ A3	1:500	Drawn	Checked	Approved	
Date	Oct 2019	Date		Date	
Dwg No.	T439 - 220 - 01	Parish	Scheme	Number	Rev.