

PUBLIC PATH DIVERSION ORDER**TOWN AND COUNTRY PLANNING ACT 1990, SECTION 257****SOUTH GLOUCESTERSHIRE COUNCIL**
(FOOTPATH LPU 36 (PART) AT LAND SOUTH OF LYDE GREEN, EMERSONS GREEN)
PUBLIC PATH DIVERSION ORDER 2021

This order is made by South Gloucestershire District Council under section 257 of the Town and Country Planning Act 1990 because it is satisfied that it is necessary to divert the footpath to which this order relates in order to enable development to be carried out in accordance with planning permission PK17/1112/F granted under Part III of the Town and Country Planning Act 1990 namely: the erection of 115 dwellings on the site known as Land South of Lyde Green. The site comprises part of the major allocated urban extension, Emersons Green East, in part of the East Fringe of Bristol.

BY THIS ORDER:

1. The footpath over the land shown by a bold black line on the attached map and described in Part I of the Schedule to this order ("the Schedule") shall be diverted as provided below.
2. There shall be created to the reasonable satisfaction of South Gloucestershire District Council an alternative highway for use as a replacement for the said footpath as provided in Part 2 of the Schedule and shown by bold black dashes on the attached map.
3. The diversion of the footpath shall have effect on the date on which South Gloucestershire District Council certify that the terms of Article 2 above have been complied with.
4. The following works shall be carried out in relation to the highway described in Part 2 of the Schedule namely that the length of footpath is to be surfaced, signposted and waymarked to the satisfaction of South Gloucestershire Council.
5. BDW Trading Ltd of 710 Waterside Drive, Aztec West, Bristol BS32 4UD is hereby required to pay for the cost of carrying out the said works.
6. Where immediately before the date on which the footpath is diverted there is apparatus under, in, on, over, along or across it belonging to statutory undertakers for the purpose of carrying on their undertaking, the undertakers shall continue to have the same rights in respect of the apparatus as they then had.

Given under the Common Seal of South Gloucestershire District Council on the 1st day of December 2021.

THE COMMON SEAL of
SOUTH GLOUCESTERSHIRE
DISTRICT COUNCIL was hereunto
affixed in the presence of:-

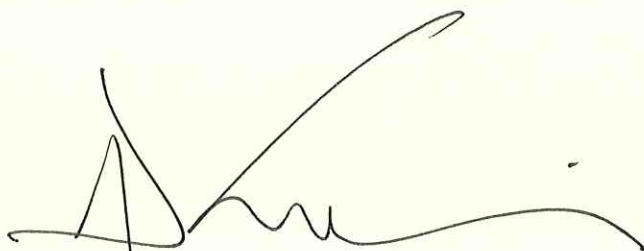

Solicitor



Authority for Sealing
Comm Min/Del Power
Seal Reg No 24913

SCHEDULE

PART 1

DESCRIPTION OF SITE OF EXISTING PATH OR WAY

That length of public footpath LPU 36 (part) in the Unitary District of South Gloucestershire in the Parish of Emersons Green which runs from Point A (grid reference ST 6787 7710) from the field boundary west of Crocus Road and running across the field in a west north westerly direction for a distance of 136 metres to Point D (grid reference ST 6773 7713), north east of The Rosary, shown by a bold black line marked A - D on the map contained in this order.

PART 2

DESCRIPTION OF SITE OF ALTERNATIVE HIGHWAY

From Point A (grid reference ST 6787 7710) from the unaffected part of LPU 36 west of Crocus Road and running in a westerly direction for a distance of 27 metres along a laid out path to Point B (grid reference ST 6784 7771) where it meets a vehicular road, then turning 90 degrees to the north to run along the pavement adjacent to the vehicular road for 40 metres to Point C (grid reference ST 6784 7714) before again turning 90 degrees in a westerly direction along the northern side of the shared space road for a distance of 102 metres to Point D (grid reference ST 6773 7713) where it meets the unaffected part of LPU 36 and having a width throughout of 2 metres and shown by a bold broken line marked A - B - C - D on the map contained in this order.

Date: October 2021

Map No: 479 PT.7076

Scale: 1:1250 at A4

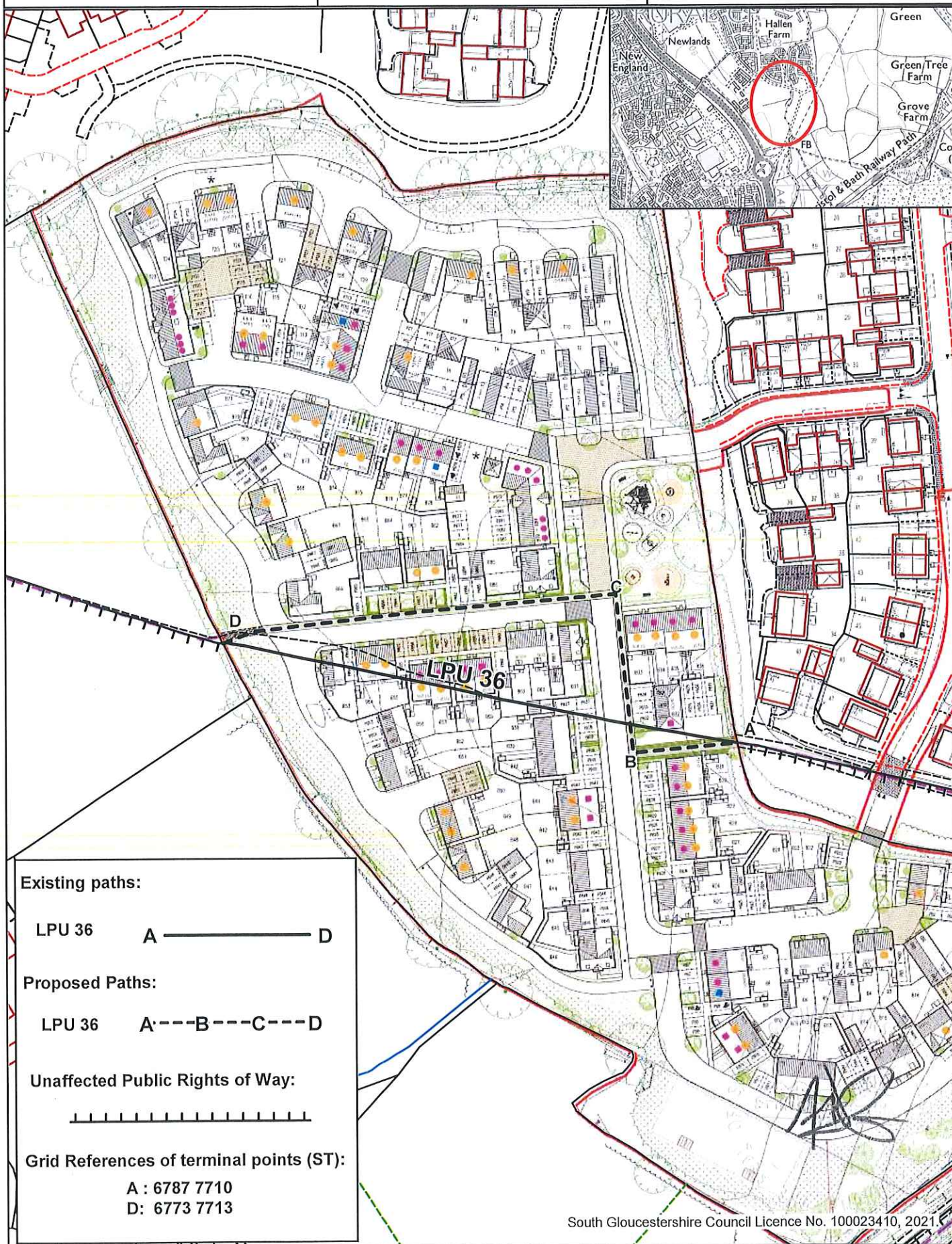

Existing paths:

LPU 36 A ————— D

Proposed Paths:

LPU 36 A - - - B - - - C - - - D

Unaffected Public Rights of Way:



Grid References of terminal points (ST):

A : 6787 7710
 D : 6773 7713