

NOTES

- All dimensions are in metres unless noted otherwise.
- Dimensions in brackets are typical.
- This drawing should not be scaled and only written dimensions should be used. Any discrepancies should be brought to the attention of this department immediately.
- The site is located on the Northeast of Bristol.

INFORMAL CONSULTATION KEY

- Traffic Regulation Orders**
- Extent of proposed 24 hour bus lane
 - Extent of proposed urban clearway with 40 mph speed limit **40**
 - Extent of proposed urban clearway with 30 mph speed limit **30**
 - Extent of proposed urban clearway with reduction of speed limit from 40 mph to 30 mph **30**
 - Extent of proposed reduction of speed limit from 40 mph to 30 mph **30**
 - Proposed ahead only restriction (no other movements permitted):
 - (b) Hambrook Lane eastbound
 - (c) Stoke Gifford Transport Link southbound
 - (d) Stoke Gifford Transport Link northbound
 - (e) Hambrook Lane westbound
 - Extent of proposed no waiting at any time restriction
- Additional information**
- Boundary of area with changes proposed as part of MetroBus scheme
 - Extent of proposed advisory cycle lane

Rev	By	Chkd	Apprvd	Date	Description

Client

CH2MHILL
 1 The Square
 Temple Quay
 Bristol BS1 6DG
 TEL: +44 (0)117 910 2580
 www.ch2m.com

Project
NORTH FRINGE TO HENGROVE METROBUS

Drawing
**INFORMAL CONSULTATION
 ZONE 2
 STOKE GIFFORD TRANSPORT LINK
 3 OF 6**

Drawn by: ETS	Date: 07/11/2014
Checked by: PF	Date: 07/11/2014
Approved by:	Date:

Drawing No.	Revision
Drawing 2.3	P4

Drawing Scale: 1:1000 @ A3

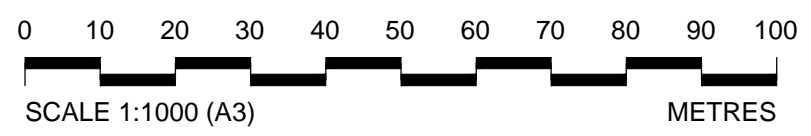
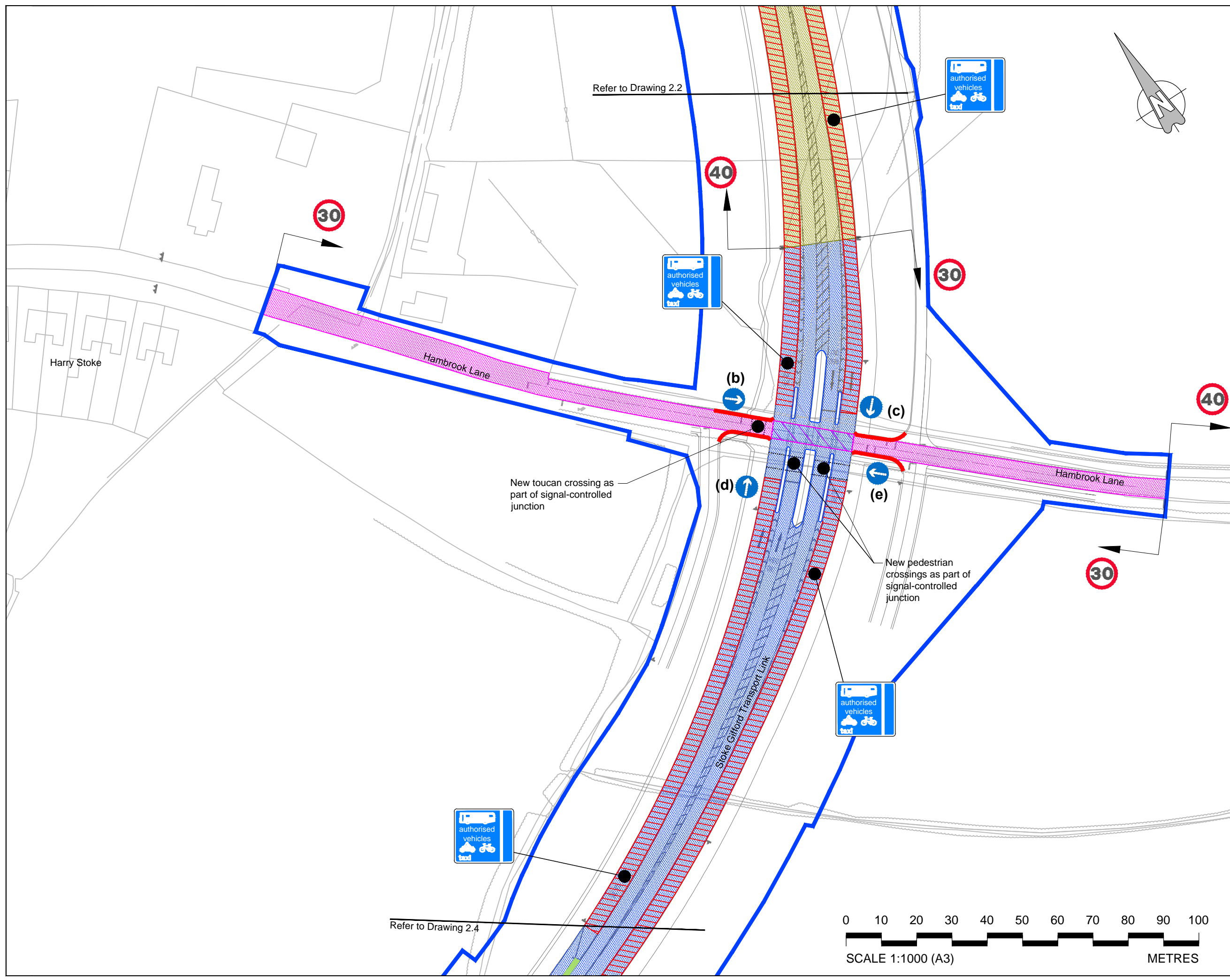

Drawing file name: U:\Projects\202388 (BS) North Fringe to Hengrove BRT Phase 2\TROLZone 2 SGT1\BMPHP-CH-ZZ-ZZ-DR-1 to 6.dwg
 User and Plot Date: 07/11/2014 11:11:11