

[Redacted]

From: [Redacted]
Sent: 28 July 2015 16:46
To: Planning LDF
Cc: [Redacted]
Subject: RE: Local Green Space Consultation - LGSD209 and LGSD202
Attachments: Mangotsfield LGSD202 supplementary plan.pdf; LGSD202 Mangotsfield football club ground.pdf

[Redacted]

Thank you for providing this confirmation.

However, it has subsequently come to my attention that part of the area which my client is objecting to the allocation of, is actually covered by a separate LGSD proposal ([LGSD202](#)).

I have highlighted the relevant area on the attached ownership plan (as we previously submitted) [in pink](#) and attached the **LGSD202** plan for clarification. This strip of land adjacent to Mangotsfield Football Club is in the ownership of our client **Taylor Wimpey UK Ltd** and has historically always be considered as a contiguous part of the larger 'field' to the south. I am not clear why this area is now being associated with the Football Club?

Be that as it may, our clients objections equally relate to this area of land (part of LGSD202) as to that identified as **LGSD209** (as per our previous submission) and so I would be grateful if you could please update your file/records with this email, and ensure that our objection is registered against both of these proposed areas.

To clarify we do not act for Mangotsfield Football Club and so I am not sure if you will be receiving a separate response from them regarding the substantive part of site **LGSD202**.

Could you please confirm receipt of this email and advise if you require any further information from me?

Regards
Andy

Andrew Ross
Associate Director

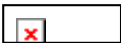

10 Queen Square
Bristol BS1 4NT



turley.co.uk



Think of the environment, please do not print unnecessarily
This e-mail is intended for the above named only, is strictly confidential and may also be legally privileged. If you are not the intended recipient please do not read, print, re-transmit, store or act in reliance on it or any attachments. Instead, please notify the sender and then immediately and permanently delete it. Turley is a trading name of Turley Associates Ltd, registered in England and Wales Registered No 2235387 Registered Office 1 New York Street, Manchester, M1 4HD.

From: Planning LDF [mailto:PlanningLDF@southglos.gov.uk]
Sent: 24 July 2015 11:50

Think of the environment, please do not print unnecessarily

This e-mail is intended for the above named only, is strictly confidential and may also be legally privileged. If you are not the intended recipient please do not read, print, re-transmit, store or act in reliance on it or any attachments. Instead, please notify the sender and then immediately and permanently delete it. Turley is a trading name of Turley Associates Ltd, registered in England and Wales Registered No 2235387 Registered Office 1 New York Street, Manchester, M1 4HD.

From: Andrew Ross
Sent: 17 July 2015 12:51
To: 'PlanningLDF@southglos.gov.uk'
Subject: Local Green Space Consultation - LGSD209

Please find attached a response on behalf of Taylor Wimpey UK Ltd in respect of this consultation - comprising a letter, your form, plans and an associated report.

I would be grateful if you could please confirm receipt.

A hard copy is also being sent.

Regards

Andy

South Gloucestershire Council . Achieving excellence for our residents and their communities, ensuring South Gloucestershire continues to be a great place to live and work

This email and any files transmitted with it from South Gloucestershire Council are confidential and intended solely for the use of the individual or entity to whom they are addressed. You should not forward it by any method to anyone else who does not have a justified 'need to know'.

If you have received this email in error please notify the South Gloucestershire Council postmaster at the address below

postmaster@southglos.gov.uk

Scanned by **MailMarshal** - M86 Security's comprehensive email content security solution. Download a free evaluation of MailMarshal at www.m86security.com

Emersons Green Parish

Green Space Code	Name of Nominated Space	Ward
LGSD202	Mangotsfield Football Club ground	Emersons Green Ward

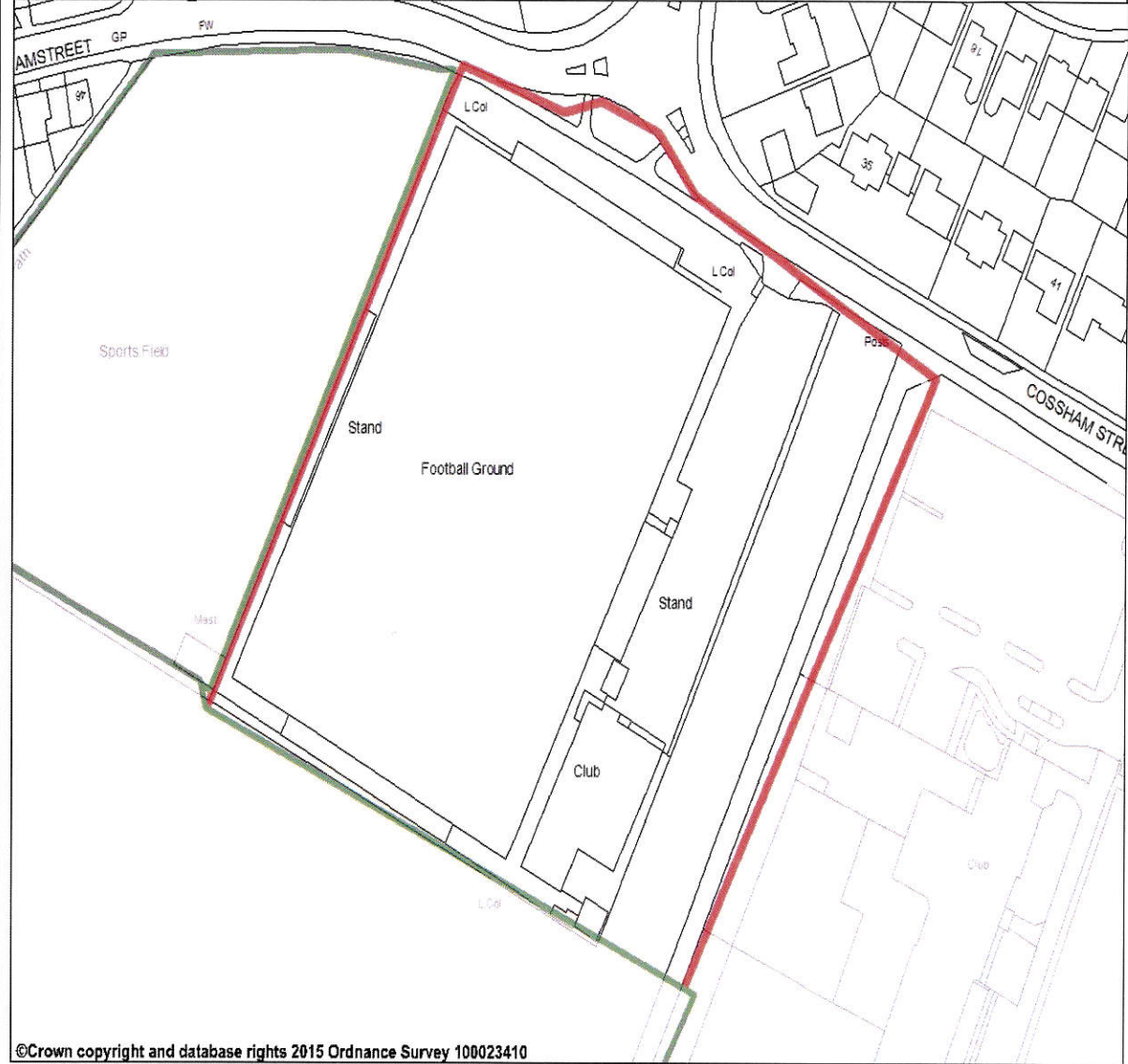

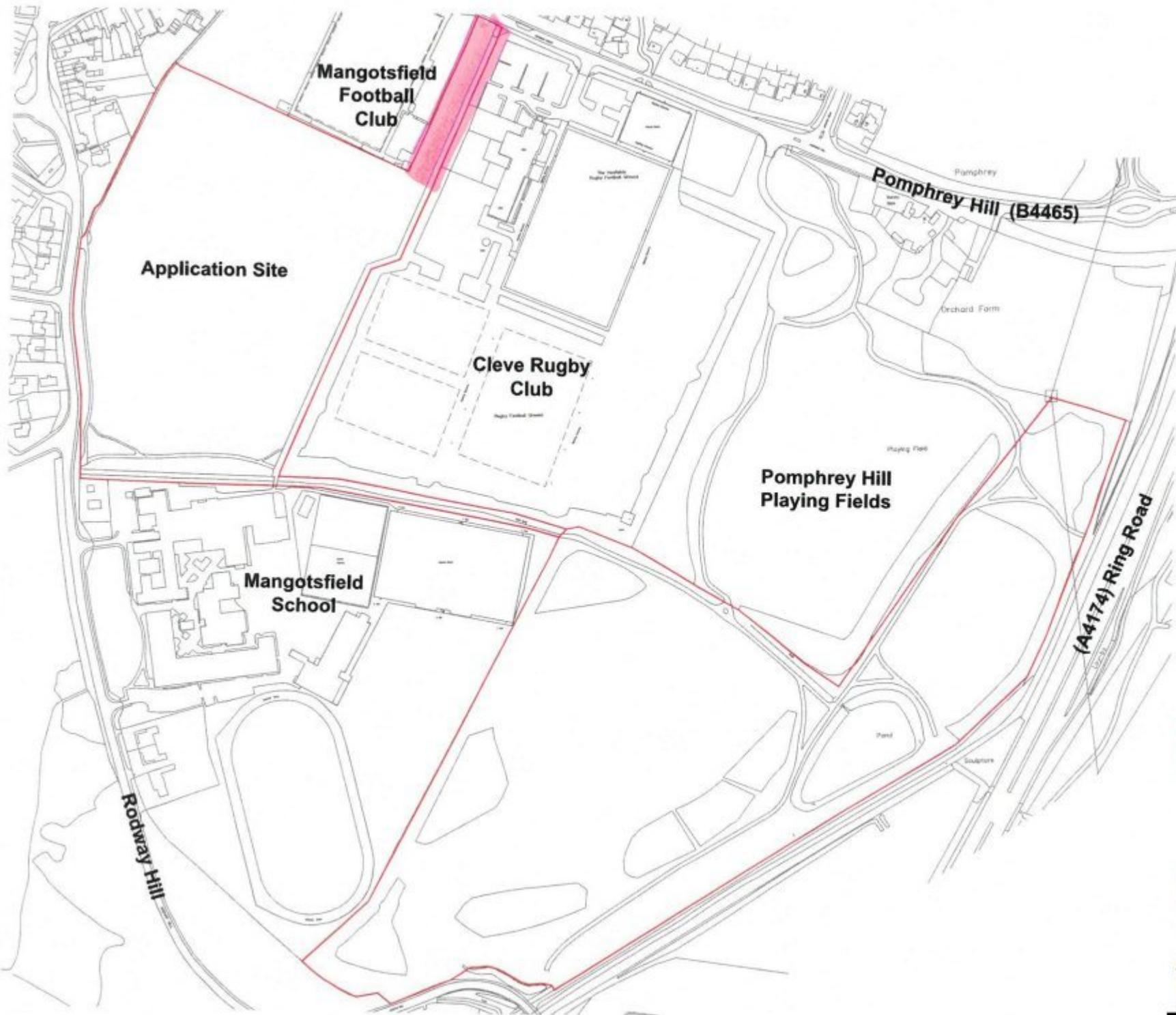

Application Site

Mangotsfield Football Club

Cleve Rugby Club

Pomphrey Hill Playing Fields

Mangotsfield School

Pomphrey Hill (B4465)

(A4174) Ring Road

Roadway Hill

 Land in ownership of Taylor Wimpey UK Ltd

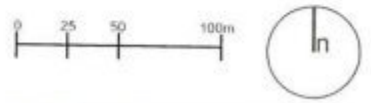

PROJECT: Land at Cosham Street - MANGOTSFIELD
 CLIENT: Taylor Wimpey - Bristol
 TITLE: Land Ownership Plan
 STATUS: FINAL

IDB NUMBER TAYA1010 DWG No: 100 REVISION: A
 DATE: 01.07.2011 SCALE: 1:2500@A3 AUTHOR: LP

TURLEYASSOCIATES

10 Quay Square, Bristol, BS1 4NT
 www.turleyassociates.co.uk

Local Green Space Consultation – June 2015 Response Form

Your name / organisation:

Emersons Green Town Council (EGTC) formerly known as Mangotsfield Rural Parish Council (MRPC)

Address and contact details (please include phone number & email address):

██████████ Town Clerk

In order to be able to proceed with the protection of the green spaces that have been put forward for designation as Local Green Spaces we must have for each space:

- details of the ownership of the land (if at all possible)
- a map of the boundaries
- an explanation of how it meets the criteria for designation and
- specific justification for why it is demonstrably special to the local community

Therefore please first check the List of Nominated Local Green Spaces and maps which can be viewed at: www.southglos.gov.uk/lgsd15 which identifies where further information on any of the above is still needed and then provide us with the additional information where necessary using this form:

PLEASE USE A SEPARATE FORM FOR EACH GREEN SPACE

Name and code of nominated space:

Please clearly reference the individual Local Green Space's code provided in both the List of nominated Local Green Spaces and the maps, available from www.southglos.gov.uk/lgsd15

LGSD202 Mangotsfield Football Club Ground

A) Ownership of Local Green Space

Please indicate if you or your organisation are the landowner:

Privately Owned – Cave Trust

If you are not the landowner can you provide their name and contact details?

Unknown

Is the land owner aware of the proposal to designate their land?

Unknown

(If you are not the landowner please now continue to Section B)

If you are the landowner, are you in support of or objecting to the proposals to designate this land?

If you are objecting to the proposals to designate your land, what are your reasons? (please refer to criteria in sections C and D below in particular)

B) Map of proposed Local Green Space

PLEASE PROVIDE A MAP WHICH SHOWS THE BOUNDARIES OF THE PROPOSED LOCAL GREEN SPACE

If not previously provided. Please see List of Nominated Local Green Spaces and Mapped, nominated Local Green Spaces to check if this is required. www.southglos.gov.uk/lgsd15

IF YOU ARE THE LANDOWNER PLEASE PROVIDE A MAP OF YOUR OWNERSHIP

This is particularly important if this differs from the area proposed for designation e.g. if you own only part of the proposed Local Green Space, see the Mapped, nominated Local Green Spaces: www.southglos.gov.uk/lgsd15

C) Does the space meet the national criteria for designation as a Local Green Space?

Please provide a response to each of the following 5 criteria - where information has not already been provided or is incorrect in the List of nominated Local Green Spaces. (Table 1 of the Local Green Space Designation Updated Guidance Note (June 2015) www.southglos.gov.uk/lgsd15 provides further details of the criteria and guidance on what sort of information you may wish to submit):

1. Is the proposed space subject to a planning permission for development? (See Criteria 1 in the guidance note)

No / Unknown

2. Is the proposed space the subject of an allocation, or proposal to allocate, for development in the Local Plan? (See Criteria 2 in the guidance note)

Unknown / No Neighbourhood Plan exists

3. Is the proposed space an extensive tract of land and is it local in character? (See Criteria 3 in the guidance note)

Yes

4. Is the space within close proximity to the community it serves? (See Criteria 4 in the guidance note)

Yes

5. Is the specific space demonstrably special to the local community? e.g. not a blanket designation (see Criteria 5 in the guidance note)

Supports local football league and junior clubs.

D) Why is the space of particular local significance?

Please use the following response box to provide specific evidence as to how at least one of the following criteria is relevant:

Please state which criterion, 6-11, are relevant to the nominated space. Table 2 of the Local Green Space Designation Updated Guidance Note (June 2015) www.southglos.gov.uk/lgsd15 provides further details on the criteria and guidance on what sort of information you may wish to submit to justify how the space is of particular local significance and demonstrably special to the community that use it:

6. The proposed space is of particular local significance because of its beauty
7. The proposed space is of particular local significance because of its historic significance
8. The proposed space is of particular local significance because of its recreational value
9. The proposed space is of particular local significance because of its tranquillity
10. The proposed space is of particular local significance because of its richness of wildlife
11. The proposed space is of particular local significance because of another reason not covered by criteria 6-10.

Comments Submitted in August 2014

8.

Commercial sports facility with full sized league football pitch, for Mangotsfield United football club.

Comments from Emersons Green Town Council - June 2015.

The Town Council recommends the proposed designation.

The map is correct

Please return completed forms by close of business on 30th July 2015:

By e-mail: PlanningLDF@southglos.gov.uk

By post: Strategic Planning Policy and Specialist Advice Team, South Gloucestershire Council, Environment and Community Services Department, PO Box 299, Civic Centre, High Street, Kingswood, Bristol, BS15 0DR.

Viewing documents

The consultation documents can be viewed from: www.southglos.gov.uk/lgsd15

The consultation documents are also available to view online at:

- South Gloucestershire Libraries (please refer to www.southglos.gov.uk/libraries for locations and opening times); and
- The Council's One-Stop Shops, from 8.45am - 5pm Mondays to Wednesdays and 8.45am - 4.30pm Thursdays and Fridays, in the following locations:
 - Thornbury Library, St Mary Street, Thornbury, BS35 2AA
 - Yate, Kennedy Way, BS37 4DQ (access via West Walk)
 - Kingswood Civic Centre, High Street, Kingswood, BS15 9TR
 - Patchway Hub, Rodway Road, Patchway, BS34 5PE

Data protection

The information collected as part this consultation will also be used by the Council in accordance with the data protection principles in the Data Protection Act 1998. The purposes for collecting this data are: to assist in plan making; and to contact you, if necessary, regarding the planning consultation process. Some of the data may be made public as it will form part of the evidence base used to inform the creation of planning policy documents. The above purposes may require public disclosure of any data received on the response form, in accordance with the Freedom of Information Act 2000.